

# AVIGNON

LIGHT INDUSTRIAL BUILDING

297A Rue du Petit Mas

Building A



WAREHOUSE FOR RENT ↗ WAREHOUSE FOR RENT ↗ WAREHOUSE FOR RENT

Warehouse	5,578 m <sup>2</sup>
Offices	673 m <sup>2</sup>
Additional storage	231 m <sup>2</sup>



FOR GROWTH ↗ SPACE FOR GROWTH ↗

# Warehouse + office

Avignon

Recently renovated light industrial building ideally suited for distribution or light manufacturing.

Avignon

Warehouse: **€95/m²**

Offices: **€120/m²**

Additional storage: **€50/m²**



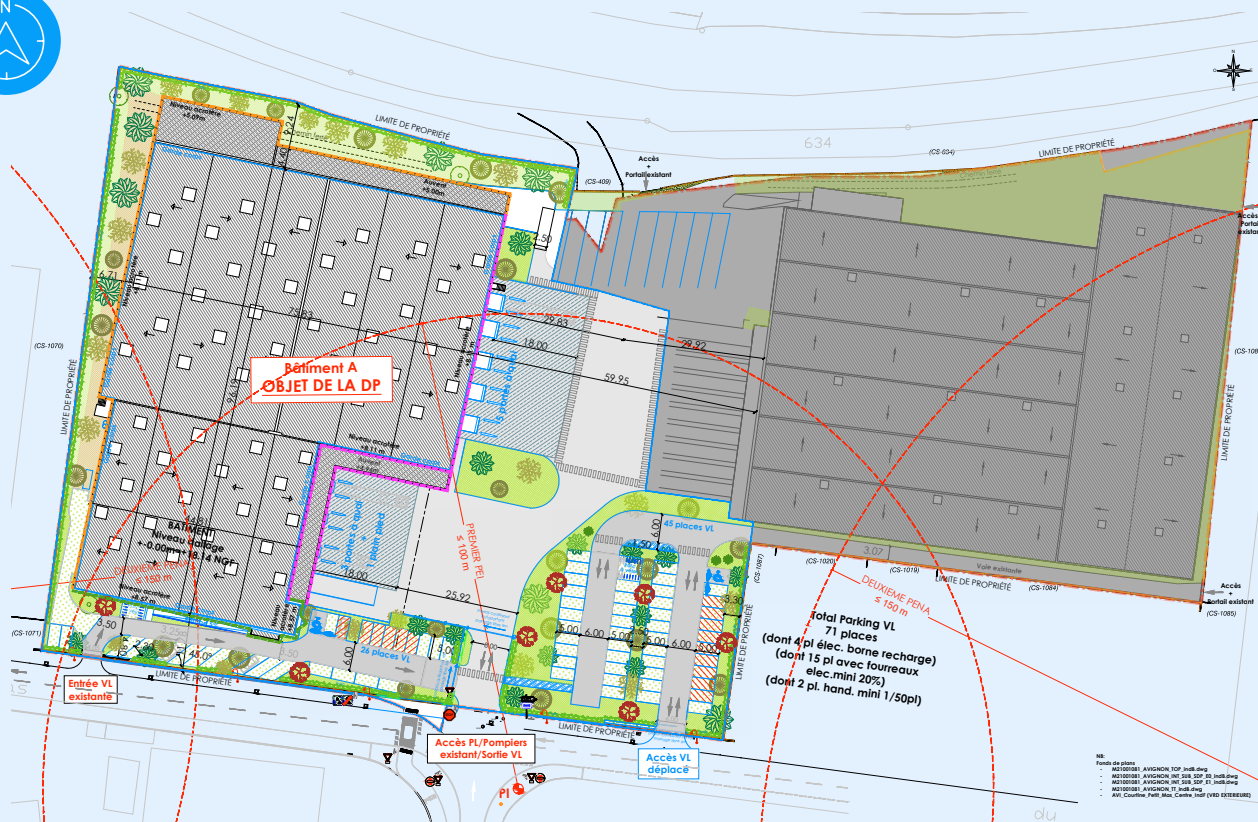





# Building Specs

## Warehouse

- Surface area: **5,578 m<sup>2</sup>**
- Free height: **approx. 7 m**
- Structure: **Steel**
- Lighting: **LED**
- Loading docks: **8**
- Sectional gates: **1** (Optional: Ground-level access with a ramp)



# Building Specs

## Office

- Surface area: **673 m<sup>2</sup>**
- Parking spaces: **26**
- Lighting: **LED**
- **Heat pumps**



## PROVENCE-ALPES-CÔTE D'AZUR

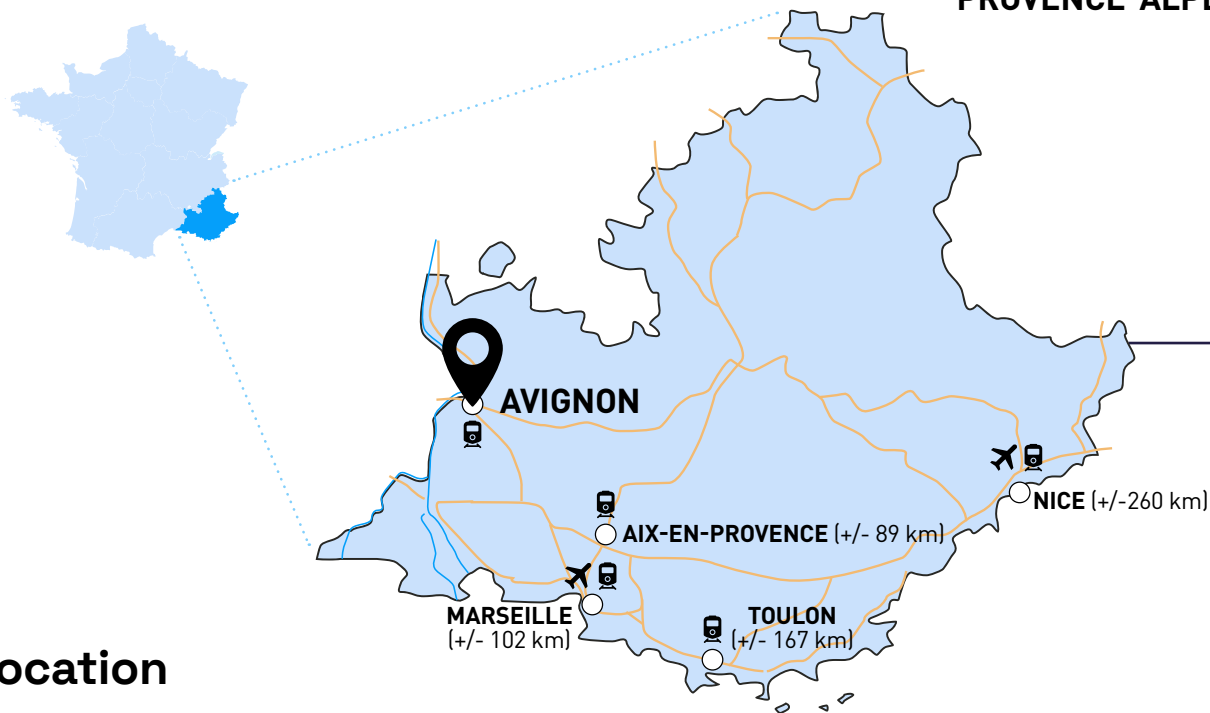

## Location

Offering excellent accessibility, the property's strategic location provides direct access to the **N100, A7** and **A9 highways**, and is just 5 minutes from the TGV station.





# A sustainability-led property



## Onsite PV Installation

Fitted with PV installations, Montea's logistics properties generate local green energy and reduce CO<sub>2</sub> emissions. **Tenants are offered this energy at a discounted rate.**



## Lighting

**LED lighting** with motion sensors.



## Materials

As part of its commitment to the transition towards a **Circular Economy**, Montea is constantly assessing the market to ensure it uses the latest, **most innovative materials** that are easy to repair, dismantle, reuse and recycle.



## Heating

Heat pumps for offices.

**Air treatment:** ventilation and dual-flow air handling unit.

**Emission:** VRF system (Variable Refrigerant Flow) 2-pipe system.





Contact



**Nastasia Dabala**

nastasia.dabala@montea.com

+33 1 83 92 25 00

or visit **montea.com**

All information provided by Montea is solely for information purposes and only intended for the addressee. We take great care when compiling information and we believe it to come from reliable sources. We cannot however accept any responsibility for its accuracy.



**SPACE FOR GROWTH ↗ SPACE FOR GROWTH ↗ SPACE FOR GROWTH ↗ SPA**

**France** 🇫🇷

**Contact person**

Nastasia Dabala

nastasia.dabala@montea.com

+33 1 83 92 25 00

**Address**

18-20 Place de

la Madeleine

FR-75008 Paris

**The Netherlands** 🇳🇱

Entrada

Ellen Pankhurststraat 1c

NL-5032 MD Tilburg

+31 6 23 24 56 57

**Germany** 🇩🇪

Mindspace (office 506)

Neue Mainzer strasse 66-68

60311 Frankfurt am Main

Tel.: 49 151 424 638 11

**Belgium** 🇧🇪

Industriezone III Zuid

Industrielaan 27 bus 6

BE-9320 Erembodegem

Tel.: +32 494 22 40 91

